

Signal Towers / Modular Signal Towers

**Siren element 8 tne 24VDC BK**



Part No.: 685.839.55



MECHANICAL DATA	
Height	53 mm
Diameter	70 mm
Materials	PC
Housing colour	Black
Protection category	IP65
Working temperature minimum	-30°C
Working temperature maximum	+50°C
Weight with packaging	75 g
Product weight	60 g
ELECTRICAL DATA	
Operating voltage	24V
Operating voltage type	DC
Operating voltage tolerance	+/- 10%
Rated operational voltage	24 VDC
Rated operational current	30 mA
Rated inrush current	500 mA
Protection class	Protection class 3
Pollution degree	3
Request to external PSU	SELV/PELV
ACOUSTIC DATA	
Volume (max) at 1m distance	102,0 dB (A)
Acoustic signal image	Multi-tone
Number of tones	8 tone
Acoustic service life	5,000 h minimum
APPROVAL DATA	
Conforms with CE	Yes
WEEE	Yes
Conforms with ATEX-directive	No
Conforms with CCC	No
Conforms with UL	No
Conforms with FCC	No
Conforms with IC	No
EAC certificate available	No
Conforms with UKCA (Importer)	Yes (WERMA (UK) Ltd.)
Conforms with AS-I	No
ICAO Certification	No

! For additional installation and mounting information, refer to the appropriate user guide at [www.werma.com](http://www.werma.com). This printed copy is for information only and is subject to alteration.

Signal Towers / Modular Signal Towers

**Siren element 8 tne 24VDC BK**

Conforms with DNV	No
Conforms with RoHS CN	No
Conforms with VdS	No

**DRAWING**

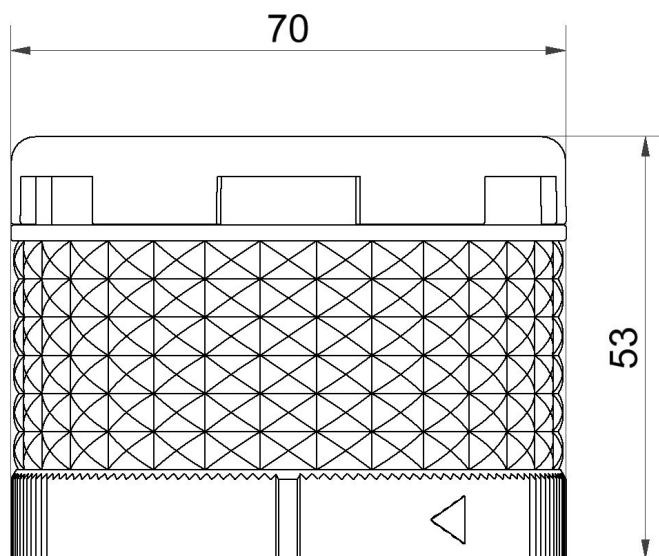

For additional installation and mounting information, refer to the appropriate user guide at [www.werma.com](http://www.werma.com). This printed copy is for information only and is subject to alteration.