

Signal Towers / Modular Signal Towers

**Buzzer element contin/pulse 24VDC BK**

Part No.: 685.829.55

**MECHANICAL DATA**

|                             |       |
|-----------------------------|-------|
| Height                      | 53 mm |
| Diameter                    | 70 mm |
| Materials                   | PC    |
| Housing colour              | Black |
| Protection category         | IP65  |
| Working temperature minimum | -30°C |
| Working temperature maximum | +50°C |
| Weight with packaging       | 1 g   |
| Product weight              | 1 g   |

**ELECTRICAL DATA**

|                             |                    |
|-----------------------------|--------------------|
| Operating voltage           | 24V                |
| Operating voltage type      | DC                 |
| Operating voltage tolerance | +/- 10%            |
| Rated operational voltage   | 24 VDC             |
| Rated operational current   | 20 mA              |
| Rated inrush current        | 500 mA             |
| Protection class            | Protection class 3 |
| Pollution degree            | 3                  |
| Request to external PSU     | SELV/PELV          |

**ACOUSTIC DATA**

|                             |                               |
|-----------------------------|-------------------------------|
| Volume (max) at 1m distance | 95,0 dB (A)                   |
| Acoustic signal image       | Continuous tone<br>Pulse tone |
| Audio frequency             | 2900 Hz                       |
| Acoustic service life       | 5,000 h minimum               |

**APPROVAL DATA**

|                               |                       |
|-------------------------------|-----------------------|
| Conforms with CE              | Yes                   |
| WEEE                          | Yes                   |
| Conforms with ATEX-directive  | No                    |
| Conforms with CCC             | No                    |
| Conforms with UL              | No                    |
| Conforms with FCC             | No                    |
| Conforms with IC              | No                    |
| EAC certificate available     | No                    |
| Conforms with UKCA (Importer) | Yes (WERMA (UK) Ltd.) |
| Conforms with AS-I            | No                    |



For additional installation and mounting information, refer to the appropriate user guide at [www.werma.com](http://www.werma.com). This printed copy is for information only and is subject to alteration.

Signal Towers / Modular Signal Towers

**Buzzer element contin/pulse 24VDC BK**

|                       |    |
|-----------------------|----|
| ICAO Certification    | No |
| Conforms with DNV     | No |
| Conforms with RoHS CN | No |
| Conforms with VdS     | No |

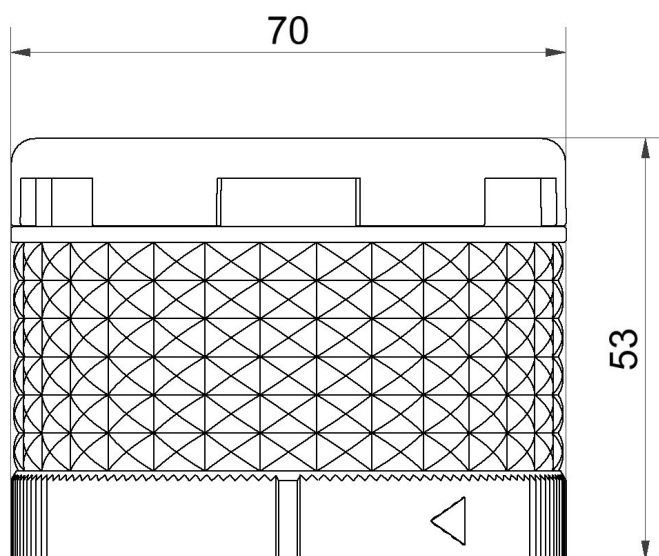
**DRAWING**

For additional installation and mounting information, refer to the appropriate user guide at [www.werma.com](http://www.werma.com). This printed copy is for information only and is subject to alteration.